

- BASE BID: AREA #1 AND #2**
1. MILL & HAUL OFF EXISTING ASPHALT: 4,120 SY
 2. 2" TYPE C HOT MIX ASPHALT: 1,420 SY
 3. REMOVE HEADER CURB: 1,410 LF
 4. 18" CURB & GUTTER: 1,410 LF
 5. 6" HEADER CURB: 10 LF
 6. 24" CONCRETE FLUME: 12 LF
 7. SAW-CUT, REMOVE & PATCH: 200 SY
 8. PARKING LOT STRIPING: 2,000 CY
 9. UNDERCUT UNSUITABLE SOIL (12"):
- BID ALTERNATES: AREA #3**
1. MILL & HAUL OFF EXISTING ASPHALT: 1,240 SY
 2. 2" TYPE C HOT MIX ASPHALT: 1,240 SY
- BID ALTERNATES: AREA #4**
1. MILL & HAUL OFF EXISTING ASPHALT: 750 SY
 2. 2" TYPE C HOT MIX ASPHALT: 750 SY

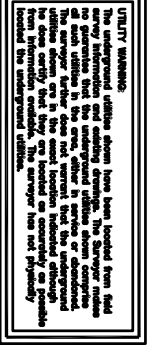
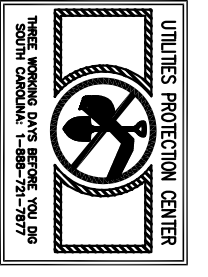
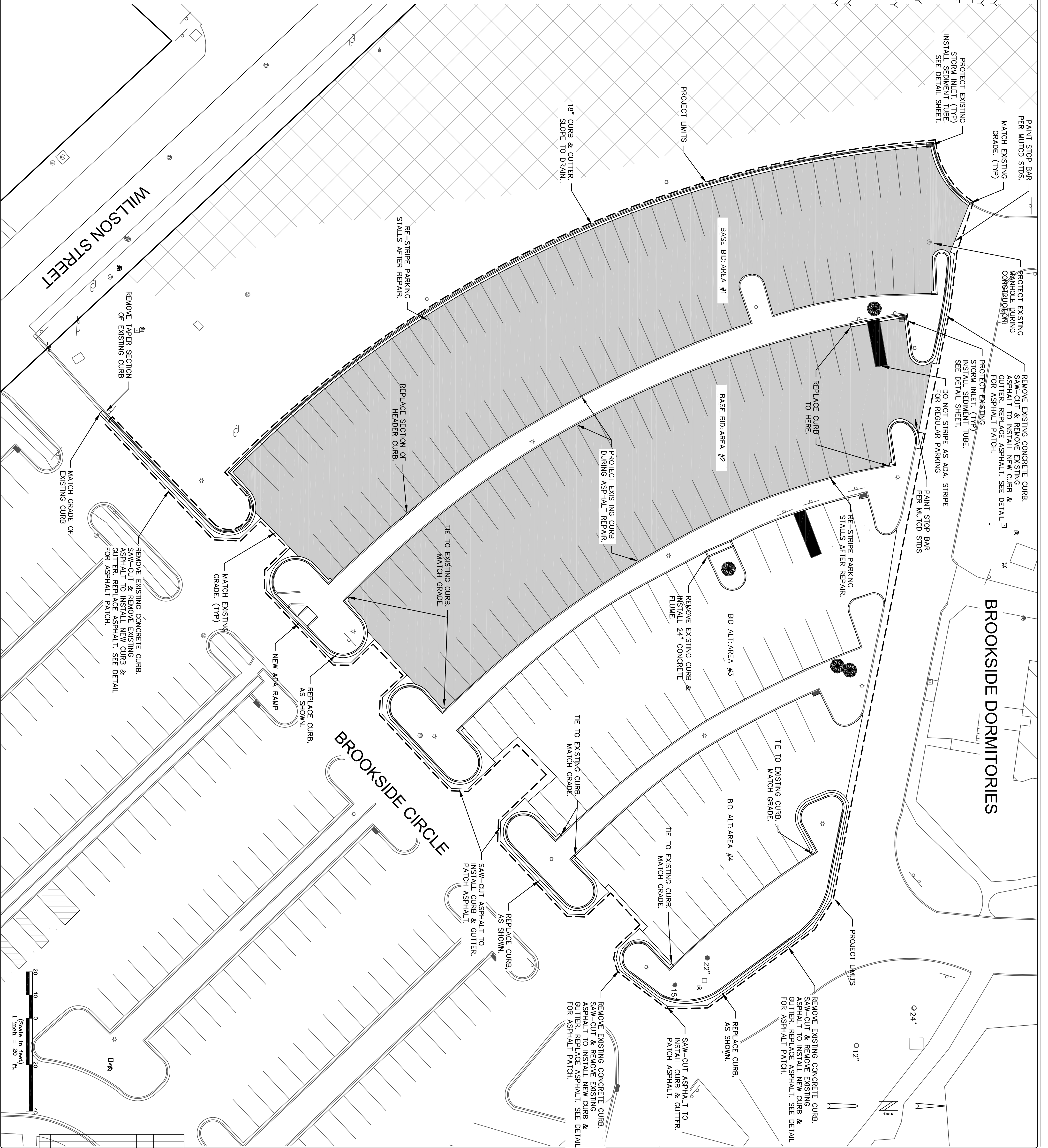

NO.	REVISED	CHKD	DATE

DESIGNED BY: DEFII	CHECKED: DEFII	JOB NUMBER: 2021-004
DRAWN: DPH	APPROVED: DEFII	DATE: 03/05/21

CIVIL
SITE
PLAN

**ASPHALT PAVEMENT REPAIR
BROOKSIDE CIRCLE PARKING LOT
FOR
LANDER UNIVERISTY
GREENWOOD, SOUTH CAROLINA**

